



---

# ELECTRIC CAN SEALING MACHINE

---



---

USER MANUAL  
April 2023



## Naturally innovative

A leader in equipment and products for the maple syrup industry, LAPIERRE EQUIPMENT distinguishes itself by its ability to innovate and develop high-performance solutions. This is what enables it to make significant changes in production techniques and processes in order to increase crop yield of high quality syrup.

LAPIERRE EQUIPMENT has a wealth of experience accumulated over three generations of maple syrup producers. These are also people driven by passion and a deep desire to help the industry evolve with the utmost respect for nature.

## Honoured to serve your customers

LAPIERRE EQUIPMENT is honoured to actively assist maple syrup producers during the sugar season.

Today you have made a wise choice for at least two good reasons: the superior quality of our products and the exceptional quality of all our expert advisers in the region.

We sincerely appreciate your trust. And we will be happy to serve you again in your future equipment purchases, regardless of the size of your sugar bush.

Thank you!

---

### Lapierre Equipment Inc.

99 Rue de l'Escale, Saint-Ludger (QC) Canada G0M 1W0

819 548.5454 | 1 833 548.5454 | [info@elapierre.com](mailto:info@elapierre.com)

[www.elapierre.com](http://www.elapierre.com)

---

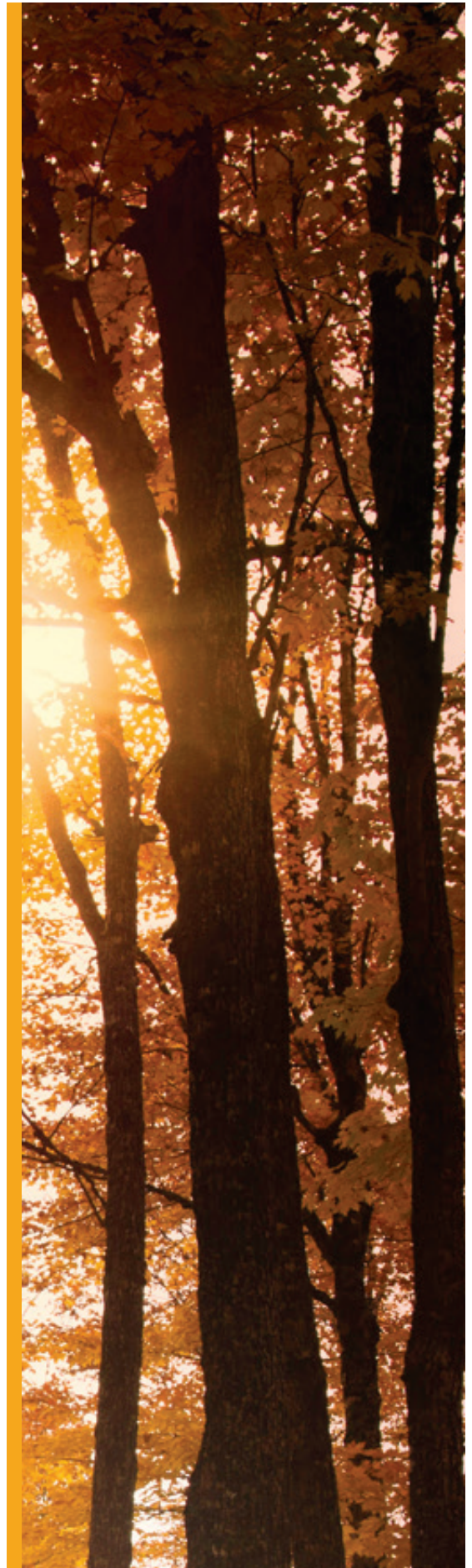



---

# ELECTRIC CAN SEALING MACHINE

---

Please note the information required below when dealing with customer service professionals. You can easily find this information on the **data plate** on your electric can sealing machine as well as on **your invoice**. You can also refer to *Section 1* of this manual for additional information.



The model shown may differ from your model.



## IMPORTANT INFORMATION ABOUT YOUR ELECTRIC CAN SEALING MACHINE

Customer Service: 819 548.5454 | 1 833 548.5454 | [info@elapierre.com](mailto:info@elapierre.com)

Model number: \_\_\_\_\_

Serial number: \_\_\_\_\_

Purchase date: \_\_\_\_\_

Invoice number: \_\_\_\_\_

**We will be pleased to answer any of your questions, please do not hesitate to contact us.**

---

# ELECTRIC CAN SEALING MACHINE

---



• **LATEST VERSION OF THIS USER'S MANUAL:** Please refer to our website for the latest version of this user's manual.

---

## TABLE OF CONTENTS

LAPIERRE naturally innovative .....	C2
Important information about your electric can sealing machine. ....	1
<b>SECTIONS</b>	
1. Where to find information about your equipment. ....	4
2. Safety instructions. ....	5
2.1 Instructions. ....	5
2.2 Warning. ....	5
- Electricity. ....	5
- Liquids. ....	5
- Other. ....	5
2.3 Repairs and maintenance. ....	6
3. What to check when you receive your electric can sealing machine. ....	7
3.1 Condition of your electric can sealing machine. ....	7
3.2 Purchase Order. ....	7
4. Installing your electric can sealing machine. ....	8
5. Start-up and operation procedures. ....	9
5.1 Checks and maintenance before using your electric can sealing machine. ....	9
5.2 Using your electric can sealing machine in automatic mode. ....	9
5.3 Using your electric can sealing machine in manual mode. ....	11
6. Typical illustration; part descriptions. ....	12
7. Equipment specifications. ....	13
8. Equipment cleaning and storage. ....	14
9. Our warranty (Warranty certificate). ....	15
10. Parts and consumables. ....	18

## TABLE OF ILLUSTRATIONS

ILLUSTRATION 1   Control panel of the electric can sealing machine .....	11
ILLUSTRATION 2   Typical illustration of the electric can sealing machine and descriptions of the parts ...	12



## TABLE OF WARNINGS

Important information about your electric can sealing machine .....	1
Protect children .....	6 - 9
People near the equipment .....	9
Ensure that the electric can sealing machine is used for its intended purpose .....	11
Cleaning product residue on all components .....	14
Keep your purchase invoice .....	15

## SECTION 1 WHERE TO FIND INFORMATION ABOUT YOUR EQUIPMENT

---

When you contact our customer service professionals, it is important to have certain information about your equipment on hand as you will be asked for it.

You can easily find this information on the **data plate** on your electric can sealing machine as well as on **your invoice**.

<b>Information about the equipment</b>	<b>Data plate</b> (affixed to your equipment)	<b>Invoice</b>
Model number	✓	✓
Serial number	✓	✓
Purchase date	-	✓
Invoice number	-	✓

### 2.1 INSTRUCTIONS

- It is important to read, understand and follow the instructions and warnings contained in this user manual.
- This manual must be stored in a known place and accessible at all times by staff.
- All product operators must be familiar with the contents of this manual.
- Certain instructions may not apply to your equipment, depending on your model.

### 2.2 WARNING

#### **Electricity**

- Before turning On the equipment, check the power supply specifications. You will find it on the data sheet of your electric can sealing machine. Also check the specifications of the electrical circuit you intend to use. Then make sure that the two components are compatible.
- Never connect the power cord to an overloaded electrical circuit.
- Never use extension cords that are longer than necessary or of a smaller gauge.
- Make sure that the electrical cords are in good working order, that they are not pinched or stripped, and that they are not altered in any way that could affect their safe use.
- Never touch a bare wire while it is powered. Then turn off the power and repair the equipment before turning it back on and using it.
- The user must check the grounding circuit. Some equipment must be used or connected to other equipment that is also equipped with a grounding circuit. Disabling or a malfunctioning of this circuit may cause equipment operating conditions that are hazardous to its users.
- Always unplug the power cord from the equipment when it is not going to be used for a long period of time.

#### **Liquids**

- Never expose the electric can sealing machine to rain or excessive condensation.
- Never bring liquids into contact with the electronic components.
- Unless otherwise specified, never submerge the electrical components of this equipment.

#### **Other**

- Always keep hair, hands, and jewellery away from equipment components that are operating, or may unexpectedly start up.
- Never place heavy objects on top of your equipment, as their weight could damage parts of your electric can sealing machine.

## 2.3 REPAIRS AND MAINTENANCE

- Stop using the equipment immediately if a malfunction is detected.
- Only LAPIERRE EQUIPMENT authorized personnel may carry out repairs on this equipment.
- Unauthorized modifications or repairs may result in hazardous operating conditions. These conditions may also cause varying degrees of injury to users.
- Always disconnect the power supply before performing any maintenance or repairs.
- It is recommended that equipment inspections and maintenance be carried out diligently to ensure optimal operational integrity. See *Section 8: Equipment cleaning and storage* for more information.
- Never disassemble the electrical components of this equipment.



### **PROTECT CHILDREN**

- Never allow children to use this equipment.
- Never leave children unattended in proximity to this equipment, whether it is switched On or not.



## SECTION 3 WHAT TO CHECK WHEN YOU RECEIVE YOUR ELECTRIC CAN SEALING MACHINE

---

Here is a checklist to complete when you receive your electric can sealing machine.

### 3.1 CONDITION OF YOUR ELECTRIC CAN SEALING MACHINE

- Check the condition of the electric can sealing machine as soon as it arrives.
- Although LAPIERRE EQUIPMENT applies rigorous quality control in the plant and before shipping, please note, photograph and advise your LAPIERRE EQUIPMENT representative of any defects or imperfections that may be observed on the day your equipment is received.

### 3.2 PURCHASE ORDER

- Have the purchase order on hand.
- Ensure by a visual inspection that you have received all the items indicated on the purchase order.
- Also ensure that all items are in good condition.

## SECTION 4 **INSTALLING YOUR ELECTRIC CAN SEALING MACHINE**

---

Your electric can sealing machine must be installed on a horizontal and perfectly stable surface.

Make sure that the electrical cord between the equipment and the outlet cannot be accidentally snagged by an object or person.

## SECTION 5 START-UP AND OPERATION PROCEDURES

---

This electric can sealing machine is designed to seal lids on standard round cans. It is distinguished by its simple and convenient operation.

Here are the procedures for starting and operating the equipment.



### PROTECT CHILDREN

- Never allow children to use this equipment.
- Never leave children unattended in proximity to this equipment, whether it is switched On or not.



Also be especially cautious with other **PEOPLE NEAR THE EQUIPMENT**, whether they are children, family members, guests, as well as with pets.

## 5.1 CHECKS AND MAINTENANCE BEFORE USING YOUR ELECTRIC CAN SEALING MACHINE

Before using your electric can sealing machine it is important to check and perform the following operations.

1. Thoroughly clean the lifting plate (*Illustration 2 No. 5*) and all parts used for sealing.
2. Lubricate any parts that require lubrication.
3. Perform a hermetic test on cans that you have just sealed.
  - We recommend that you perform this test with several cans filled with carbonated water.
  - A visual inspection should allow you to quickly notice a hermetic problem. You can also let the can sit upside down on a flat surface and visually inspect it a few seconds later.
4. Adjust the crimping rollers (*Illustration 2 No. 10*) as needed, if you notice a sealing problem.
  - Although the crimping rollers have been adjusted at the factory, you may need to make an additional adjustment while using your electric can sealing machine.

## 5.2 USING YOUR ELECTRIC CAN SEALING MACHINE IN AUTOMATIC MODE

By plugging the power cord into the electrical outlet, the POWER ON led indicator light (*Illustration 1 No. 1*) located on the front base of the sealing machine will light up and the equipment is ready to operate.

**PEDAL NOTE** | If you wish to use the foot pedal to start the automatic sealing operation, plug its cord into the socket (*Illustration 2 No. 13*) located on the rear base of the sealing machine.

## SECTION 5 Start-up and operation procedures (continued)

---

1. Place the lid on the can.
  - The lid should completely seal the opening of the can.
2. Place the can on the lifting plate (*Illustration 2 No. 5*) of the sealing machine.
3. Set the Manual/Automatic toggle switch (*Illustration 1 No. 4*), located on the front base of the sealing machine, to AUTOMATIC mode.
4. Turn the Off/On toggle switch (*Illustration 1 No. 3*), located on the front base of the sealing machine to the ON mode.
5. Activate the automatic sealing operation by pressing the START push button (*Illustration 1 No. 2*) located on the front base of the sealing machine once.
  - You can also control this operation by pressing the foot pedal once.
  - The sealing machine will then hermetically fix the lid on the can.
  - The sealing process starts and stops automatically.
6. Remove the sealed can.
  - It is recommended to make a visual check on the first few cans.
7. Continue the operation by repeating steps 1 to 6 as needed.

**IMPORTANT** | Stop using the equipment immediately if a malfunction is detected.

- Inspect the sealing machine, determine and correct the problem, continue the crimping operation.
- Contact your LAPIERRE EQUIPMENT service center if the problem cannot be resolved.

## SECTION 5 Start-up and operation procedures (continued)

ILLUSTRATION 1 | Control panel of the electric can sealing machine

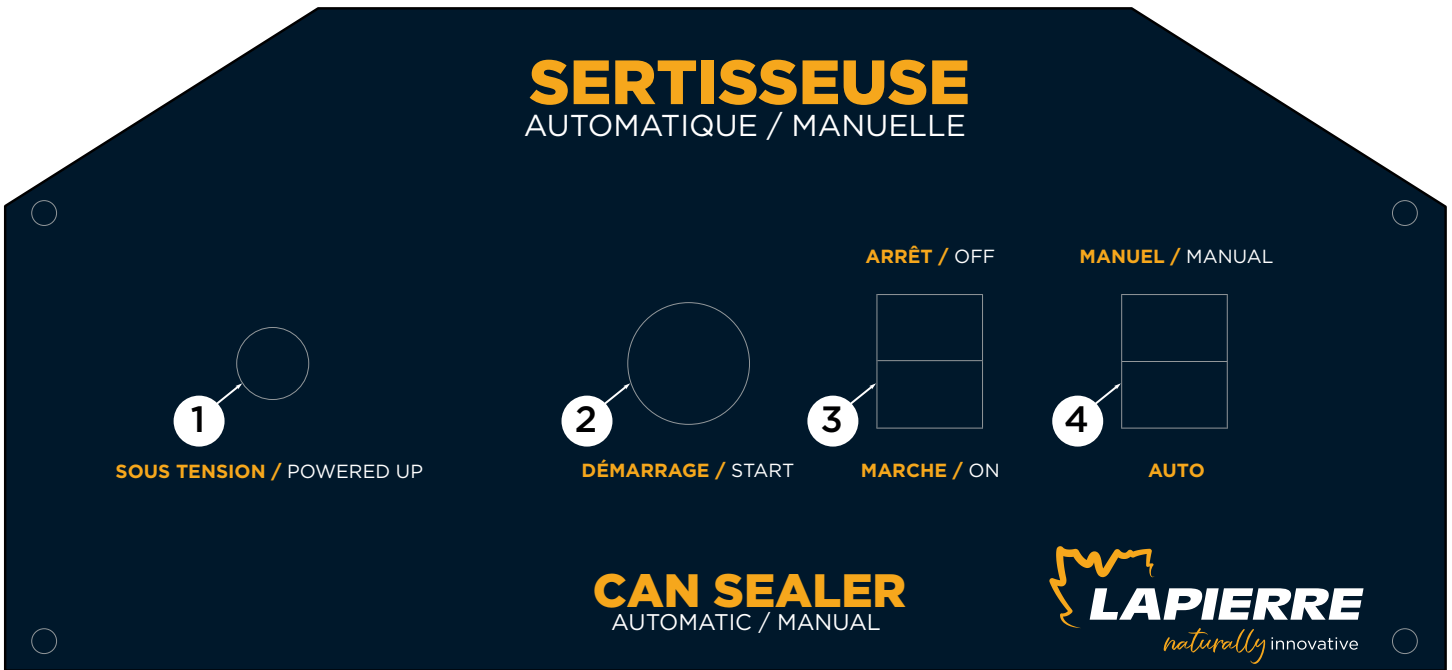

1	LED indicator light	Power on
2	Push button	Start
3	Toggle switch	Off/On
4	Toggle switch	Manual/Automatic



It is the responsibility of the operator to **ENSURE THAT THE ELECTRIC CAN SEALING MACHINE IS USED FOR ITS INTENDED PURPOSE**. If this is not the case, LAPIERRE EQUIPMENT will not be responsible for any damage or loss resulting from a hermetic problem with the cans.

### 5.3 USING YOUR ELECTRIC CAN SEALING MACHINE IN MANUAL MODE

It is possible to operate your can sealing machine in manual mode.

To do this, you need to:

1. Set the Manual/Automatic toggle switch (*Illustration 1 No. 4*), located on the front base of the sealing machine, to MANUAL.
2. Activate the Manual sealing operation by continuously pressing the START push button (*Illustration 1 No. 2*) located on the front base of the sealing machine.

## SECTION 6 TYPICAL ILLUSTRATION; PART DESCRIPTIONS

ILLUSTRATION 2 | Typical illustration of the electric can sealing machine and descriptions of the parts

### Electric can sealing machine EM100-000009XX

#### No. Part description

- 1 Cam shaft
- 2 Support plate
- 3 Upper chuck
- 4 Sealing hub
- 5 Lifting plate
- 6 Screw rod
- 7 Clamping nut
- 8 Lifting rod
- 9 Lifting sleeve rod
- 10 Crimping rollers
- 11 Motor
- 12 Vertical column
- 13 Foot pedal socket
- 14 Power cord

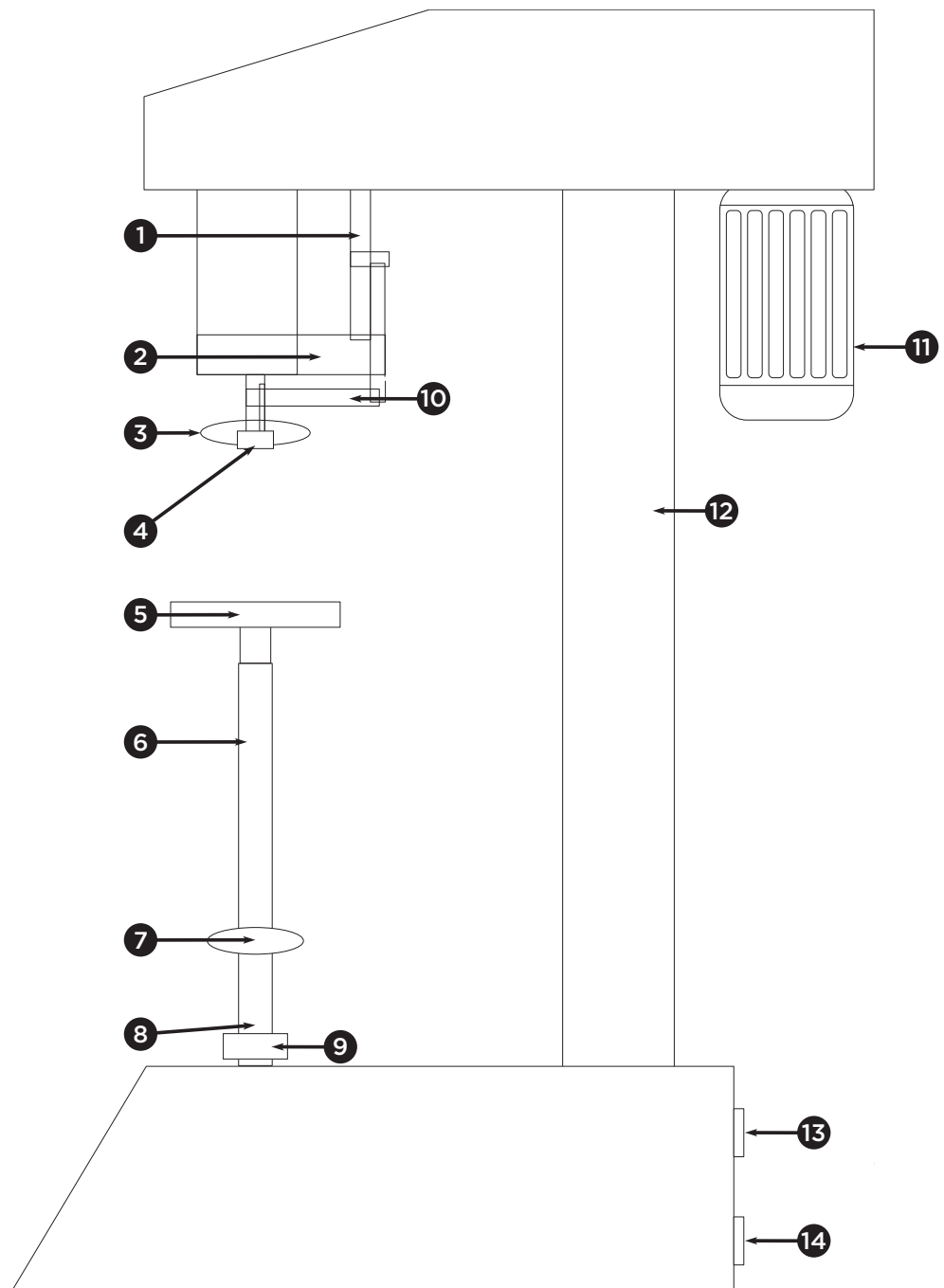

## SECTION 7 EQUIPMENT SPECIFICATIONS

---

The following is a list of the main technical specifications of the electric can sealing machine.

• Model number	<b>EM100-000009XX</b>
• Production capacity	10 to 15 cans per minute
• Electrical box	120 volts, 1 phase
• Weight of the machine	60 kg (132.28 lb)
• Can sealing machine dimensions	60 D x 30 W x 78 H cm (1.97 x 0.98 x 2.56 ft)

## SECTION 8 EQUIPMENT CLEANING AND STORAGE

---

- The stainless steel components of your equipment must be cleaned with a product specifically designed for this purpose. **Do not use flammable liquids.**
- Never use abrasive products, products containing chlorine or muriatic acid (also called hydrochloric acid) to clean the components of your electric can sealing machine.
- The use of wire brushes and steel wool should also be avoided.
- Thoroughly clean the lifting plate (*Illustration 2 No. 5*), all parts used for sealing and other exterior components of the electric can sealing machine.
- Lubricate any parts that require lubrication.



During prolonged storage, even the slightest **CLEANING PRODUCT RESIDUE ON ALL COMPONENTS** will obviously lead to inconvenience and damage at the beginning of the next season. Rinse each cleaned component thoroughly.





---

## WARRANTY CERTIFICATE

---

1. Two-year warranty
2. Warranty certificate exclusions
  - 2.1 Observed conditions
  - 2.2 Costs and losses
3. Disclaimer of liability
4. Making your warranty claim



### KEEP YOUR PURCHASE INVOICE

It is very important to keep the original invoice for the purchase of your equipment or a legible copy of it. Otherwise, LAPIERRE EQUIPMENT INC. will not accept your warranty claim.

*The term MANUFACTURER is used for LAPIERRE EQUIPMENT in order to lighten the text.*

## 1. TWO-YEAR WARRANTY

The MANUFACTURER warrants that any new product is free from manufacturing, material and workmanship defects. The warranty is valid for a period of two years from the date of purchase of the product. It applies when the product meets normal conditions of installation, use and maintenance.

**PRODUCT DEFECT.** The appearance of a defect before the expiry date of the warranty must be reported immediately to the MANUFACTURER. The MANUFACTURER will then repair or replace the defective parts with equivalent new parts.

**DEFECTIVE PARTS.** Replaced defective parts become the property of the MANUFACTURER. They are recovered during the after-sales service process.

**AESTHETICS.** The aesthetic appearance of the products - parts and equipment - is covered by a warranty covering 7 days from the date of delivery.

## **2. WARRANTY CERTIFICATE EXCLUSIONS**

### **2.1 OBSERVED CONDITIONS**

This warranty becomes null and void where one or more of the following conditions are observed.

#### **2.1.1 An altered, modified or removed serial number**

#### **2.1.2 Product damaged by:**

##### **2.1.2.1 User**

- Use deemed abusive or negligent.
- Accident caused by the user.

##### **2.1.2.2 Failure to comply with user manual instructions**

- Failure by the user to follow the instructions in the user manual: safety instructions, installation of the equipment, start-up and operating procedures, maintenance and cleaning of the equipment, as well as any other installation recommendations provided by the MANUFACTURER.

##### **2.1.2.3 Installation, modification, repair**

- Installation in a place not suitable for normal use.
- Unauthorized repair or modification - not approved by our service centre - performed by the customer.
- A repair or modification carried out by a third party not authorized by the MANUFACTURER.

##### **2.1.2.4 Parts**

- The use of parts other than original MANUFACTURER parts.
- Use of parts obtained through a service centre, technician or distributor not authorized by the MANUFACTURER.
- Use of parts that cause deterioration or damage to the product.

##### **2.1.2.5 Electricity**

- A variation, electrical overload or excessive voltage.
- Poor power supply quality or electrical connections.

##### **2.1.2.6 Cleaning products**

- The use of cleaning products or acids that are not recommended, or used without following the recommendations of their respective manufacturers.

##### **2.1.2.7 Non-controllable events**

- Events that are beyond the MANUFACTURER's control such as mechanical shock; water damage or flooding; fire or burning; storm, earthquake or other natural or man-made disasters.

### **2.2 COSTS AND LOSSES**

This warranty does not cover the following costs or losses.

#### **2.2.1 Costs for:**

- making the product accessible during a service call,
- the trip of the authorized technician during a service call,

## SECTION 9 Our warranty (Warranty certificate) (continued)

---

- service calls for reasons other than those provided for in the warranty. The warranty applies when a defect or malfunction or a defect in manufacture, material or workmanship appears,
- service calls associated with product start-up at the beginning of the season, and shutdown at the end of the season or post-season. However, costs may be covered if specified in the purchase contract,
- service calls received when the warranty expires, i.e., two years from the date of purchase of the product,
- replacement of parts due to normal wear and tear such as seals, insulation joints and gaskets,
- annual equipment tune-ups.

### 2.2.2 For losses of:

- income caused by the quality of the syrup,
- production related to the provisions covered by this warranty.

## 3. DISCLAIMER OF LIABILITY

The MANUFACTURER shall not be liable for incidental or consequential damages or implied property damage.

The MANUFACTURER shall not be liable for any direct or consequential loss of time, production or profits, inconvenience, cost of equipment acquisition or parts replacement or storage due to a warranty claim.

## 4. MAKING YOUR WARRANTY CLAIM

The following is the procedure for making a warranty claim.

- Contact your representative or distributor, our service centre or our head office to submit your warranty claim and plan the necessary after-sales service operation.
- IMPORTANT | For any claim, **the customer must submit a copy of their invoice**. Otherwise, the MANUFACTURER will not accept your claim.
- The MANUFACTURER will then proceed with an inspection of your equipment and confirm whether your warranty claim is accepted. If so, the MANUFACTURER will carry out an after-sales service operation in accordance with the provisions specified in Section 1. TWO-YEAR WARRANTY.
- The functioning equipment will then be returned to the customer in a *condition comparable* to that in which it was received. This *comparable condition* will have been previously determined by the MANUFACTURER and/or one of its representatives or distributors.
- This warranty after-sales service operation **does not extend the warranty period** of the equipment. The end date of the warranty remains the same, i.e., two years from the date of purchase of the product.

*Warranty certificate: August 2022 (V03)*

## SECTION 10 PARTS AND CONSUMABLES

---

Parts for your electric can sealing machine or any other equipment manufactured at LAPIERRE EQUIPMENT are available at our main plant in Saint-Ludger, Québec, Canada and at our service centers in Waterloo, Québec, Canada and Swanton, Vermont, USA. However, do not hesitate to contact us to locate the distributor nearest you.

### **HEAD OFFICE and MAIN PLANT**

Lapierre Equipment Inc.  
99 Rue de l'Escale  
Saint-Ludger (QC)  
GOM 1W0

Toll Free 1 833 548.5454  
Telephone 819 548.5454  
Fax 819 548.5460  
info@elapierre.com

### **SERVICE CENTER and PRODUCTION PLANT**

Lapierre-Waterloo-Small Inc.  
201 Rue Western  
Waterloo (QC)  
JOE 2N0

Toll Free 1 833 548.5454  
Telephone 450 539.3663  
Fax 450 539.2660  
info.lws@elapierre.com

### **SERVICE and DISTRIBUTION CENTER**

Lapierre USA Swanton  
102 Airport Access Road  
Swanton, VT  
05488

Telephone 802 868.2328  
Fax 802 868.9281  
info.usa@elapierre.com

**[www.elapierre.com](http://www.elapierre.com)**









We sincerely appreciate your trust.

**Thank you!**



LAPIERRE EQUIPMENT © All rights reserved - 2023

99 Rue de l'Escale, Saint-Ludger (QC) Canada G0M 1W0  
819 548.5454 | 1 833 548.5454 | [info@elapierre.com](mailto:info@elapierre.com) | [www.elapierre.com](http://www.elapierre.com)